

BIDDING DRAWINGS FOR 2025 PAVEMENT MAINTENANCE AT THE GLENCOE MUNICIPAL AIRPORT GLENCOE, MN

BIDDING DOCUMENTS

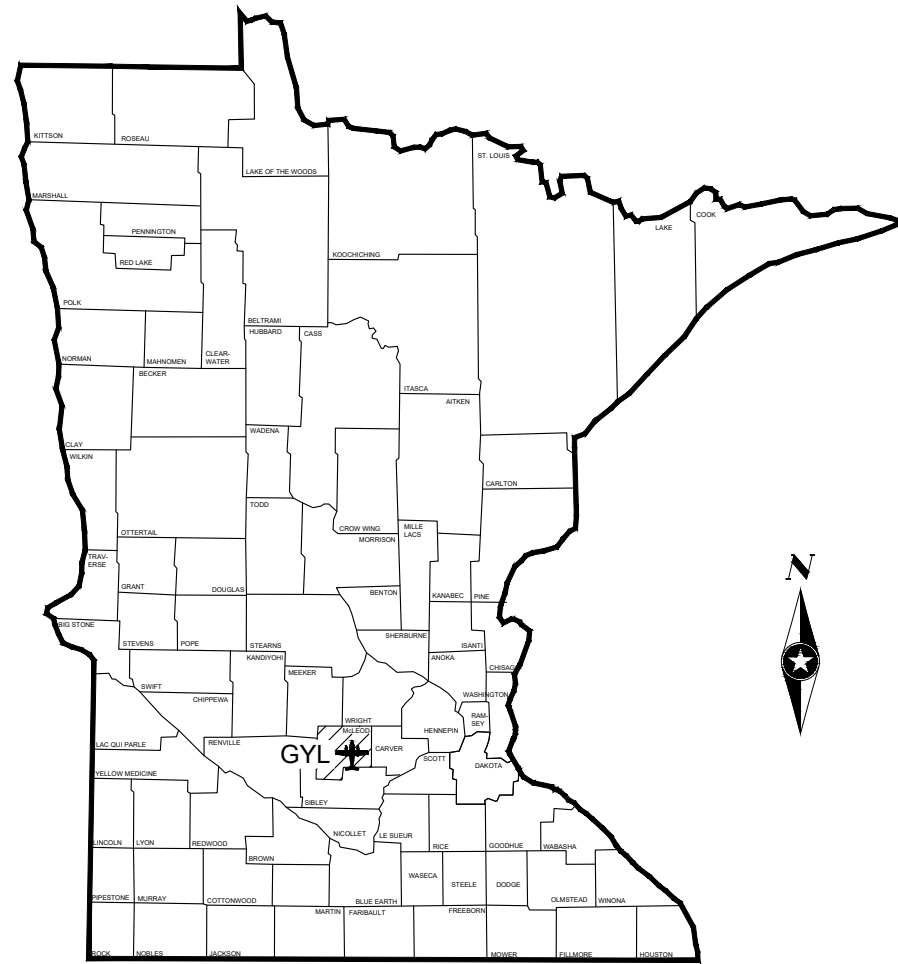

A.I.P. NO. 3-27-0158-016-2025
S.P. NO. A4301-41



STATE MAP
NO SCALE

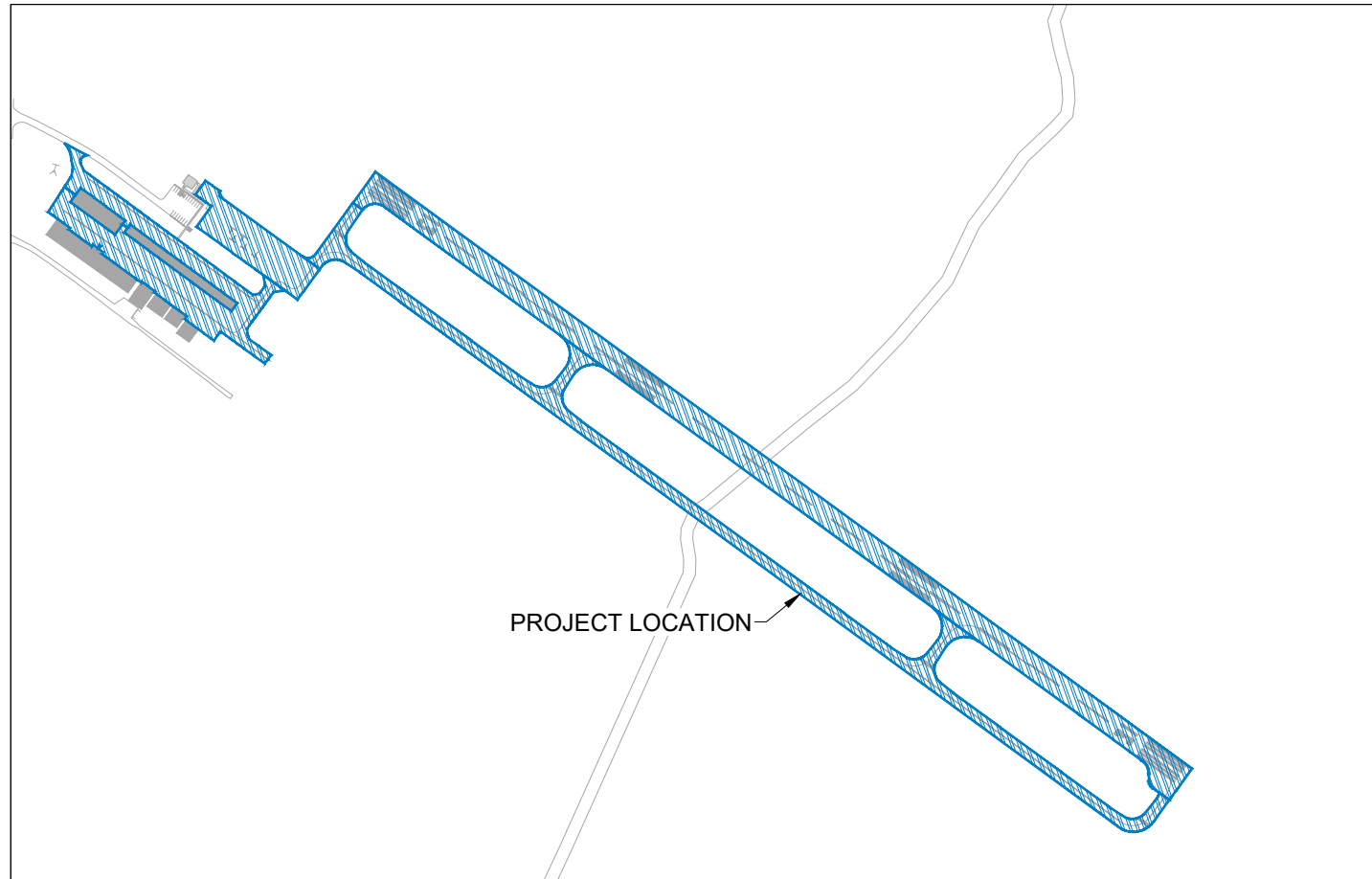

PROJECT LOCATION MAP
NO SCALE

Sheet List Table	
Sheet Number	Sheet Title
G000	TITLE SHEET
G100	CONSTRUCTION SAFETY PLAN
G101	CONSTRUCTION SAFETY PLAN DETAILS
G200	PHASING PLAN
G300	PAVEMENT ELIGIBILITY FIGURE
C100	PAVEMENT MAINTENANCE PLAN AND QUANTITIES
C200	PAVEMENT MAINTENANCE DETAILS
C300	PAVEMENT MARKING PLAN

GOPHER STATE ONE CALL

(800) 252-1166 (651) 454-0002

NOTE:
THE SUBSURFACE UTILITY QUALITY INFORMATION IN THIS PLAN IS LEVEL D. THIS UTILITY QUALITY LEVEL WAS DETERMINED ACCORDING TO THE GUIDELINES OF C/ASCE 38-02 ENTITLED "STANDARD GUIDELINES FOR THE COLLECTION AND DEPICTION OF EXISTING SUBSURFACE UTILITY DATA."



Know what's below.
Call before you dig.

**PRINT IN COLOR
FOR BEST
RESULTS**

FAA AC 150/5370-10H SHALL GOVERN, WHERE APPLICABLE, FOLLOWED BY THE 2020 EDITION OF THE MINNESOTA DEPARTMENT OF TRANSPORTATION "STANDARD SPECIFICATIONS FOR CONSTRUCTION", EXCEPT AS MODIFIED BY THE SPECIFICATIONS FOR THIS PROJECT.



OFFICE OF AERONAUTICS
6020 28TH AVE S, STE 102
MINNEAPOLIS, MINNESOTA - U.S.A. 55450

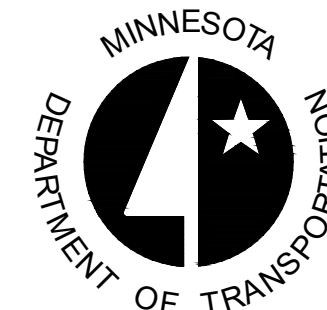

OFFICE OF AERONAUTICS
395 JOHN IRELAND BLVD
ST. PAUL, MINNESOTA - U.S.A. 55107

Save: 2/6/2025 3:28 PM kmarniak Plt: 2/10/2025 1:08 PM X:\F\G\GLENCOE\182487\5-final-dsgn\51-drawings\65-Aviation\ Pavement Maintenance\Plans\CYL_182487-TT.dwg

SEH Project	GLENCOE_182487	Rev.#	Plan Revision Issue			Date	Rev.#	Sheet Revision Issue			Date
			Description	Description	Description			Description	Description		
Drawn By	KMM	#	#			#	#			#	
Designed By	KMM	#	#			#	#			#	
Checked By	AVE	#	#			#	#			#	



I HEREBY CERTIFY THAT THIS PLAN WAS PREPARED BY ME OR UNDER MY DIRECT SUPERVISION AND THAT I AM A DULY LICENSED PROFESSIONAL ENGINEER UNDER THE LAWS OF THE STATE OF MN.
Adinda Van Espen
ADINDA VAN ESPEN, PE
DATE: 02/03/2025 LICENSE NO. 55501

2025 PAVEMENT MAINTENANCE
GLENCOE, MN

TITLE SHEET

G000

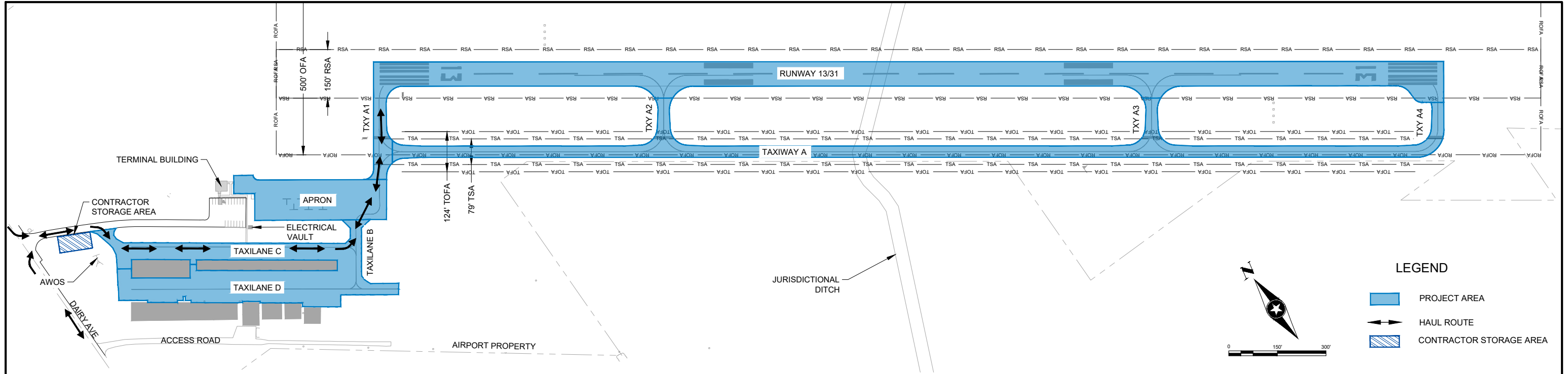

CRITICAL AIRCRAFT DATA	
AIRCRAFT APPROACH CATEGORY (AAC)	B
AIRPLANE DESIGN GROUP (ADG)	II
TAIL HEIGHT	20' - <30'
WINGSPAN	49' - <79'
RUNWAY DESIGN CODE	B-II

RUNWAY OBJECT FREE AREA		
RUNWAY	WIDTH	LENGTH BEYOND RWY END
13/31	500'-0"	300'-0"

RUNWAY SAFETY AREA		
RUNWAY	WIDTH	LENGTH BEYOND RWY END
13/31	150'-0"	300'-0"

TAXIWAY OBJECT FREE AREA	
TAXIWAY	WIDTH
TAXIWAY A	124'-0"

TAXIWAY SAFETY AREA	
TAXIWAY	WIDTH
TAXIWAY A	79'-0"

AIRPORT MANAGER:
MARK LARSON
320-864-5586

GROUND FREQUENCY:
122.800 MHZ

MAX VEHICLE SPEED:
15 MPH
UNLESS INFORMED
OTHERWISE

SCOPE OF WORK:

PAVEMENT MAINTENANCE ON ALL AIRFIELD PAVEMENTS, INCLUDING RUNWAY 13/31, THE PARALLEL TAXIWAY, AS WELL AS THE APRON AND TAXILANE PAVEMENTS. WORK INCLUDES REMOVAL OF EXISTING PAVEMENT MARKINGS (IF ALTERNATE 1 OR 2 AWARDED) AND APPLICATION OF NEW PAVEMENT MARKINGS.

PHASING:

- PHASE 1: REMOVAL OF PAVEMENT MARKINGS ON ALL AIRFIELD PAVEMENTS, IF ALTERNATE 1 OR 2 AWARDED. CRACK SEAL/MASTIC REPAIR ON ALL AIRFIELD PAVEMENTS.
- PHASE 2: SURFACE TREATMENT ON APRON AND TAXILANES. SURFACE TREATMENT ON RUNWAY AND TAXIWAYS, IF ALTERNATE 1 OR 2 AWARDED.
- PHASE 3: PAVEMENT MARKING ON APRON AND TAXILANES. PAVEMENT MARKING ON RUNWAY AND TAXIWAYS, IF ALTERNATE 1 OR 2 AWARDED.
- SEE SHEET G200 FOR A DETAILED DESCRIPTION OF PROJECT PHASING.

CONSTRUCTION SAFETY NOTES:

GENERAL SAFETY NOTES

- ALL CONSTRUCTION SHALL MEET THE MOST CURRENT REQUIREMENTS OF FAA ADVISORY CIRCULARS WHICH ARE AVAILABLE ONLINE AT WWW.FAA.GOV, OR UPON REQUEST TO THE ENGINEER. APPLICABLE ADVISORY CIRCULARS MAY INCLUDE, BUT ARE NOT LIMITED TO, 150/5340-1, 5370-2, 5210-5, AND 70/7460-1.
- THE CONTRACTOR SHALL SUBMIT A DETAILED SCHEDULE OF CONSTRUCTION OPERATIONS AT LEAST 5 DAYS PRIOR TO THE PRE-CONSTRUCTION CONFERENCE. **THE PHASING PLAN AND SCHEDULE MUST BE APPROVED BY THE ENGINEER AND THE OWNER PRIOR TO THE BEGINNING OF CONSTRUCTION OPERATIONS.**
- THE CONTRACTOR WILL ADVISE THE ENGINEER AND THE AIRPORT MANAGER 72 HOURS IN ADVANCE OF ANY PROPOSED CONSTRUCTION ACTIVITIES ON THE PROJECT.
- THE AIR OPERATIONS AREA (AOA) INCLUDES RUNWAYS, TAXIWAYS, AIRCRAFT PARKING APRONS, AND OTHER AREAS WHERE AIRCRAFT MAY MOVE UNDER THEIR OWN POWER, AS WELL AS RUNWAY PROTECTION ZONES.
- NO WORK SHALL BE ALLOWED WITHIN THE AOA UNTIL THE REQUIRED AIRFIELD CLOSURES HAVE BEEN MADE AND THE REQUIRED CLOSURE MARKERS AND BARRICADES ARE IN PLACE. ALL NECESSARY NOTICE TO AIR MISSIONS (NOTAMS) WILL BE ISSUED BY THE AIRPORT MANAGER, WHICH SPECIFICALLY DETAIL THE CURRENT STATUS OF THE AIRPORT DURING CONSTRUCTION.
- WORK MAY BE STOPPED AT ANY TIME BY THE AIRPORT MANAGER OR ENGINEER IF IT IS DETERMINED THAT PROPER SAFETY PRECAUTIONS ARE NOT BEING TAKEN.

- CONTRACTOR IS RESPONSIBLE FOR COMPLYING WITH INFORMATION ON THIS SAFETY & PHASING PLAN AND THE CONSTRUCTION SAFETY PLAN NARRATIVE CONTAINED IN THE SPECIFICATION.
- THE CONTRACTOR SHALL DEVELOP THEIR OWN SAFETY PLAN COMPLIANCE DOCUMENT DETAILING HOW THEY WILL COMPLY WITH ALL SAFETY REQUIREMENTS.

EQUIPMENT SAFETY REQUIREMENTS

- THE MAXIMUM HEIGHT OF CONSTRUCTION EQUIPMENT TO BE USED ON THE AIRPORT SHALL BE 20 FEET. IF USE OF EQUIPMENT OF GREATER THAN 20 FEET IS NEEDED, THE CONTRACTOR SHALL FILE FAA FORM 7460-1 WITH THE APPROPRIATE FAA OFFICE. FORMS ARE AVAILABLE UPON REQUEST TO THE ENGINEER.
- ALL AIRPORT AND CONSTRUCTION EQUIPMENT ON THE AIRPORT SHALL BE MARKED, LIGHTED, AND FLAGGED ACCORDING TO FAA ADVISORY CIRCULARS.
- THE CONTRACTORS PARKED EQUIPMENT OR VEHICLES (INCLUDING PERSONAL VEHICLES) SHALL BE STORED IN THE STORAGE AREA LOCATION ON THIS SHEET. LARGE EQUIPMENT THAT IS BEING USED EACH WORKING DAY THAT CANNOT BE EASILY MOVED OUT OF THE AOA MAY BE LEFT OVERNIGHT WITHIN THE AOA AT A LOCATION DESIGNATED BY THE ENGINEER.

RUNWAY CLOSURE

- CONTRACTOR TO PROVIDE ONE SET OF NON-LIGHTED RUNWAY CLOSURE MARKERS FOR THE PROJECT. SEE DETAIL ON SHEET G101 FOR MORE INFORMATION.

BARRICADES

- THE CONTRACTOR SHALL PROVIDE, PLACE, AND MAINTAIN LIGHTED LOW PROFILE BARRICADES THROUGHOUT THE DURATION OF THE PROJECT. PROVIDING AND PLACING DEVICES, MAINTENANCE, BATTERY REPLACEMENT, AND MOVEMENT ARE ALL INCIDENTAL TO MOBILIZATION.
- BARRICADES SHALL BE PLACED AT LOCATIONS AS DIRECTED BY ENGINEER TO DELINEATE CONSTRUCTION AREAS AND WILL MOVE AS WORK PROGRESSES.
- THE CONTRACTOR SHALL KEEP A MINIMUM OF 20 BARRICADES ON-SITE. ADDITIONAL BARRICADES MAY BE REQUESTED BY ENGINEER AT NO ADDITIONAL COST.

CONSTRUCTION HAUL ROUTES

- THE CONTRACTOR SHALL ESTABLISH A HAUL ROUTE IN THE GENERAL AREA INDICATED ON THE PLAN. THE EXACT LOCATION OF THE HAUL ROUTE SHALL BE REVIEWED AND APPROVED BY THE ENGINEER. THIS ROUTE SHALL BE USED FOR DELIVERY AND REMOVAL OF ALL CONSTRUCTION EQUIPMENT AND MATERIALS AND ACCESS TO THE SITE FOR ALL PERSONNEL FOR THE DURATION OF THE PROJECT.
- THE CONTRACTOR SHALL KEEP THE ROUTE AND ALL PAVEMENTS CLEAR OF DEBRIS AT ALL TIMES. AT A MINIMUM, THE ROUTE SHALL BE SWEEPED AT THE END OF EACH WORKING DAY. ADDITIONAL SWEEPING MAY BE REQUIRED IMMEDIATELY UPON THE NOTIFICATION BY ENGINEER.

- THE ROUTE AND ALL AIRFIELD PAVEMENTS SHALL BE THOROUGHLY CLEANED PRIOR TO REOPENING TO AIRCRAFT USE.

UTILITIES

- THE CONTRACTOR IS SOLELY RESPONSIBLE FOR LOCATING AND MARKING ANY AND ALL PUBLIC AND PRIVATE UTILITIES PRIOR TO BEGINNING CONSTRUCTION ACTIVITIES.** CALL GOPHER STATE ONE CALL AT 800.252.1166 AT LEAST 48 HOURS PRIOR TO COMMENCING CONSTRUCTION.
- IN THE EVENT UTILITIES ARE DAMAGED BY THE CONTRACTOR, THE CONTRACTOR SHALL REPAIR THE DAMAGED UTILITIES TO THE UTILITY OWNER'S REQUIREMENTS AT THE EXPENSE OF THE CONTRACTOR.

PENALTIES

- FAILURE TO COMPLY WITH THE SAFETY AND PHASING PLANS THAT RESULT IN A RUNWAY INCURSION OR VEHICLE DEVIATION ON THE AIRFIELD SHALL HAVE A \$1,000 PENALTY ASSESSED TO THE PRIME CONTRACTOR. A SECOND RUNWAY INCURSION OR VEHICLE DEVIATION ON THE AIRFIELD SHALL BE ASSESSED A PENALTY OF \$2,500. A THIRD RUNWAY INCURSION OR VEHICLE DEVIATION ON THE AIRFIELD SHALL RESULT IN CONTRACT TERMINATION.
- IF CONTRACTOR SHOULD FAIL TO COMPLETE THE WORK SPECIFIED, THE CONTRACTOR WILL BE ASSESSED \$500 FOR EACH ADDITIONAL HOUR THAT REQUIRES THE CLOSURE OF A RUNWAY AOA OR \$500 FOR EACH ADDITIONAL DAY THAT REQUIRES THE CLOSURE OF A TAXIWAY AOA. THESE CHARGES APPLY TO ANY ADDITIONAL TIME THAT REQUIRES THE AOA TO BE CLOSED UNLESS AN EXTENSION OF TIME IS APPROVED BY THE ENGINEER.

SCHEDULE

CONTRACTOR SHALL COMPLETE THE WORK FOR EACH PHASE AS FOLLOWS:

- PHASE 1A: LIMITED TO 2 CALENDAR DAYS
 - PHASE 1B: LIMITED TO 2 CALENDAR DAYS
 - PHASE 1C: LIMITED TO 1 CALENDAR DAY
 - PHASE 1D: LIMITED TO 1 CALENDAR DAY
 - PHASE 2A: LIMITED TO 3 CALENDAR DAYS
 - PHASE 2B: LIMITED TO 2 CALENDAR DAYS
 - PHASE 3: LIMITED TO 3 CALENDAR DAYS
- AT THE END OF EACH WORKING DAY DURING PHASE 1, THE CONTRACTOR SHALL OPEN ALL PAVEMENTS IN THAT DAY'S WORKING AREA. PAVEMENTS TO BE OPENED MUST BE FREE OF FOREIGN OBJECT DEBRIS (FOD) AND INSPECTED BY THE ENGINEER PRIOR TO OPENING. THIS DOES NOT APPLY TO PHASES 2 & 3.
 - CONTRACTOR SHALL PROVIDE NOTICE TO ENGINEER AT LEAST 7 DAYS PRIOR TO RUNWAY CLOSURE. RUNWAY CLOSURE HOURS SHALL BE 7:00 AM TO 6:00 PM.**

Save: 2/10/2025 1:04 PM kmarcihnik Plot: 2/10/2025 1:09 PM X:\F\J\G\G\EN\182487-5-final-dsgn\5-drawings\65-Aviation\Pavement Maintenance\Plans\GYL_182487-CSPP.dwg

SEH Project	GLNCOE_182487	Rev.#	Plan Revision Issue Description	Date	Rev.#	Sheet Revision Issue Description	Date
Drawn By	KMM	#	#	#	#	#	#
Designed By	KMM	#	#	#	#	#	#
Checked By	AVE	#	#	#	#	#	#

I HEREBY CERTIFY THAT THIS PLAN WAS PREPARED BY ME OR UNDER MY DIRECT SUPERVISION AND THAT I AM A DULY LICENSED PROFESSIONAL ENGINEER UNDER THE LAWS OF THE STATE OF MN.
Adinda Van Espen
ADINDA VAN ESPEN, PE
DATE: 02/03/2025 LICENSE NO. 55501

2025 PAVEMENT MAINTENANCE
GLENCOE, MN

CONSTRUCTION SAFETY PLAN

G100

Save: 2/10/2025 1:04 PM kmarchiak Plot: 2/10/2025 1:09 PM X:\F\G\GLENCOE\182487\5-final-dsgn\51-drawings\65-Aviation\Pavement Maintenance\Plans\GYL_182487-CSPP.dwg

NOTES:

1. TEMPORARY CLOSING CROSS MARKERS SHALL BE CONSTRUCTED OF YELLOW POLYVINYL FABRIC AT LEAST 8-MM THICK, PLYWOOD, OR OTHER SIMILARLY APPROVED MATERIAL.
2. THE MARKERS SHALL BE PROPERLY FASTENED AND SECURED TO PREVENT MOVEMENT.
3. TEMPORARY CLOSING CROSS MARKERS ARE YELLOW IN COLOR.
4. CONSTRUCT IN ACCORDANCE WITH FAA AC 150/5340-1.
5. EXACT INSTALLATION LOCATIONS TO BE DETERMINED BY THE ENGINEER.
6. TO BE USED FOR DAYTIME CLOSURES ONLY.

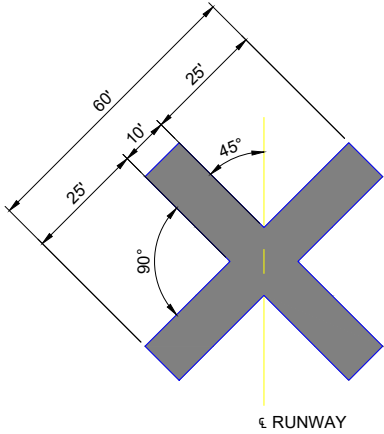

TEMPORARY CLOSING CROSS MARKERS

NTS

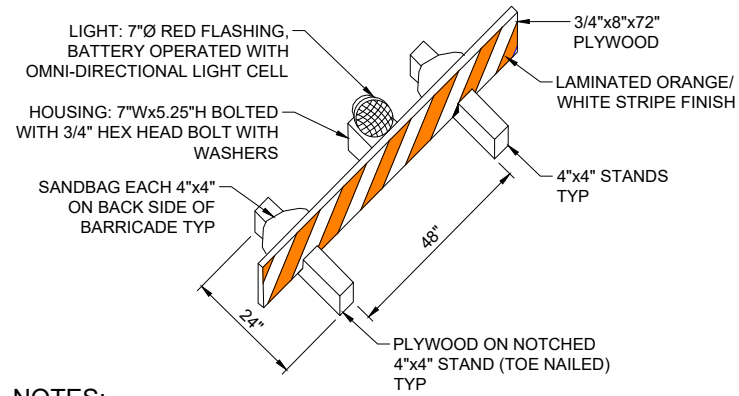

NOTES:

1. BARRICADES SHALL BE CONSTRUCTED AND PLACED A MAXIMUM OF 20' APART ACROSS THE FULL WIDTH OF CLOSED PAVEMENT PER FAA ADVISORY CIRCULAR 150/5370-2.
2. ALL LOW PROFILE BARRICADES SHALL BE CONSTRUCTED AS SHOWN UNLESS OTHERWISE APPROVED BY THE ENGINEER.

LOW PROFILE BARRICADE

NTS

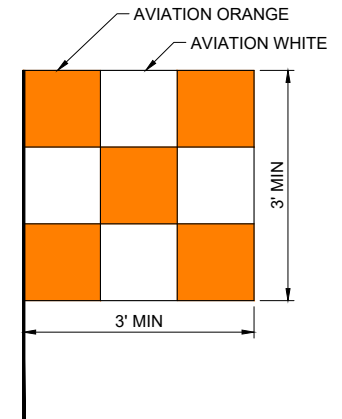

NOTE: SAFETY FLAG OR BEACON SHALL BE PROMINENTLY DISPLAYED ON ALL CONSTRUCTION EQUIPMENT.

CONSTRUCTION SAFETY FLAG

NTS

SEH Project	GLENC_182487	Rev.#	Plan Revision Issue Description	Date	Rev.#	Sheet Revision Issue Description	Date
Drawn By	KMM	#	#	#	#	#	#
Designed By	KMM	#	#	#	#	#	#
Checked By	AVE	#	#	#	#	#	#



I HEREBY CERTIFY THAT THIS PLAN WAS PREPARED BY ME OR UNDER MY DIRECT SUPERVISION AND THAT I AM A DULY LICENSED PROFESSIONAL ENGINEER UNDER THE LAWS OF THE STATE OF MN.
Adinda Van Espen
 ADINDA VAN ESPEN, PE
 DATE: 02/03/2025 LICENSE NO. 55501

2025 PAVEMENT MAINTENANCE
 GLENCOE, MN

CONSTRUCTION SAFETY PLAN DETAILS

G101

PHASE 1

REMOVAL OF PAVEMENT MARKINGS AND CRACK SEAL/MASTIC REPAIR

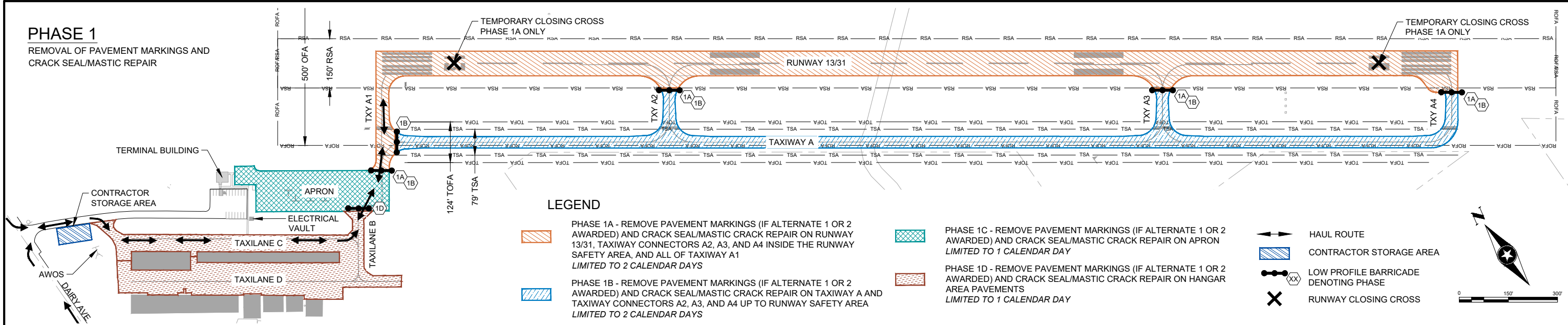

PHASE 2

SURFACE TREATMENT

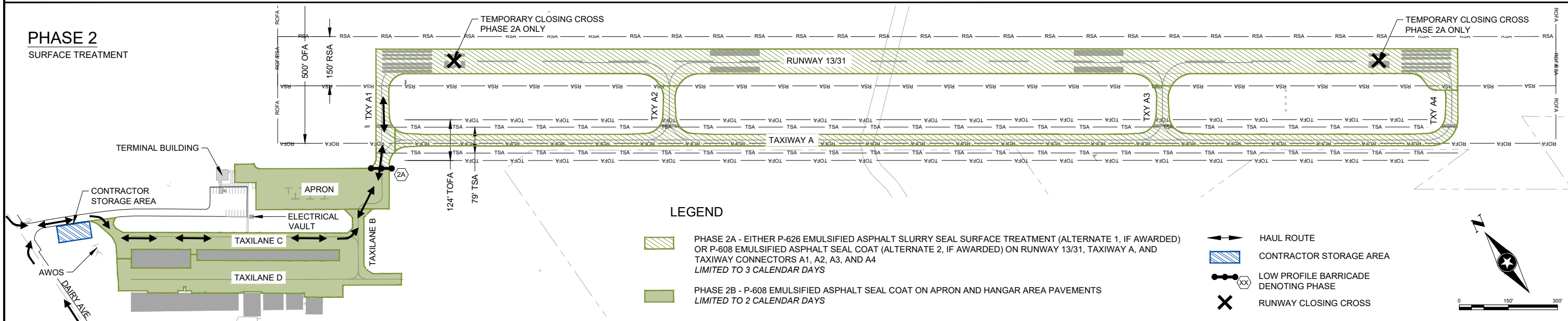

PHASE 3

PAVEMENT MARKING

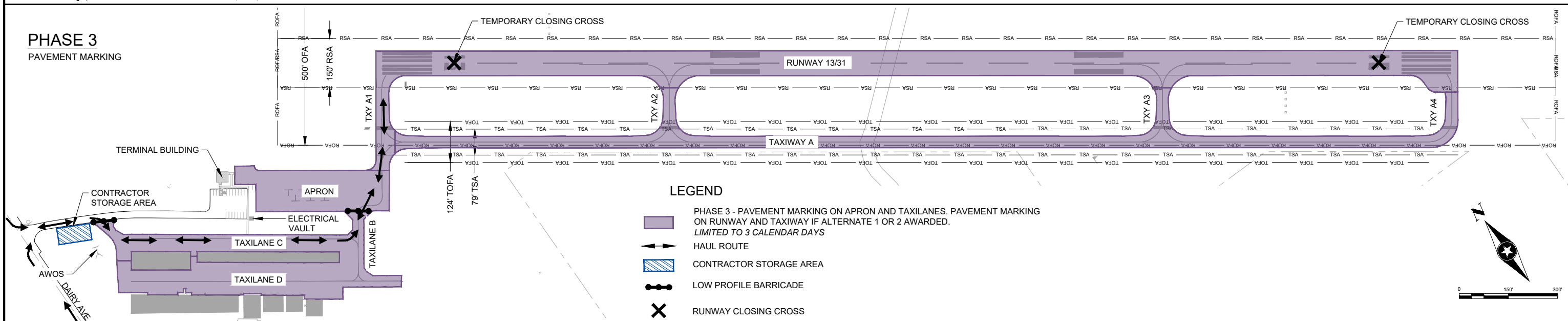

Save: 2/10/2025 1:04 PM kmarchiak Plot: 2/10/2025 1:09 PM X:\F\G\GLENCOE\182487\5-final-dsgn\51-drawings\65-Aviation\Pavement Maintenance\Plans\GYL_182487-CSPPP.dwg

SEH Project	GLENCOE_182487	Rev. #	Plan Revision Issue Description	Date	Rev. #	Sheet Revision Issue Description	Date
Drawn By	KMM	#	#	#	#	#	#
Designed By	KMM	#	#	#	#	#	#
Checked By	AVE	#	#	#	#	#	#

I HEREBY CERTIFY THAT THIS PLAN WAS PREPARED BY ME OR UNDER MY DIRECT SUPERVISION AND THAT I AM A DULY LICENSED PROFESSIONAL ENGINEER UNDER THE LAWS OF THE STATE OF MN.

Adinda Van Espen

ADINDA VAN ESPEN, PE
DATE: 02/03/2025 LICENSE NO.: 55501

SEH

2025 PAVEMENT MAINTENANCE
GLENCOE, MN

PHASING PLAN

G200

Save: 1/30/2025 4:52 PM kmarchiak Plot: 2/10/2025 1:09 PM X:\F\G\GLENCOE\182487\5-final-dsgn\51-drawings\65-Aviation\Pavement Maintenance\Plans\GYL_182487-ELIG.dwg

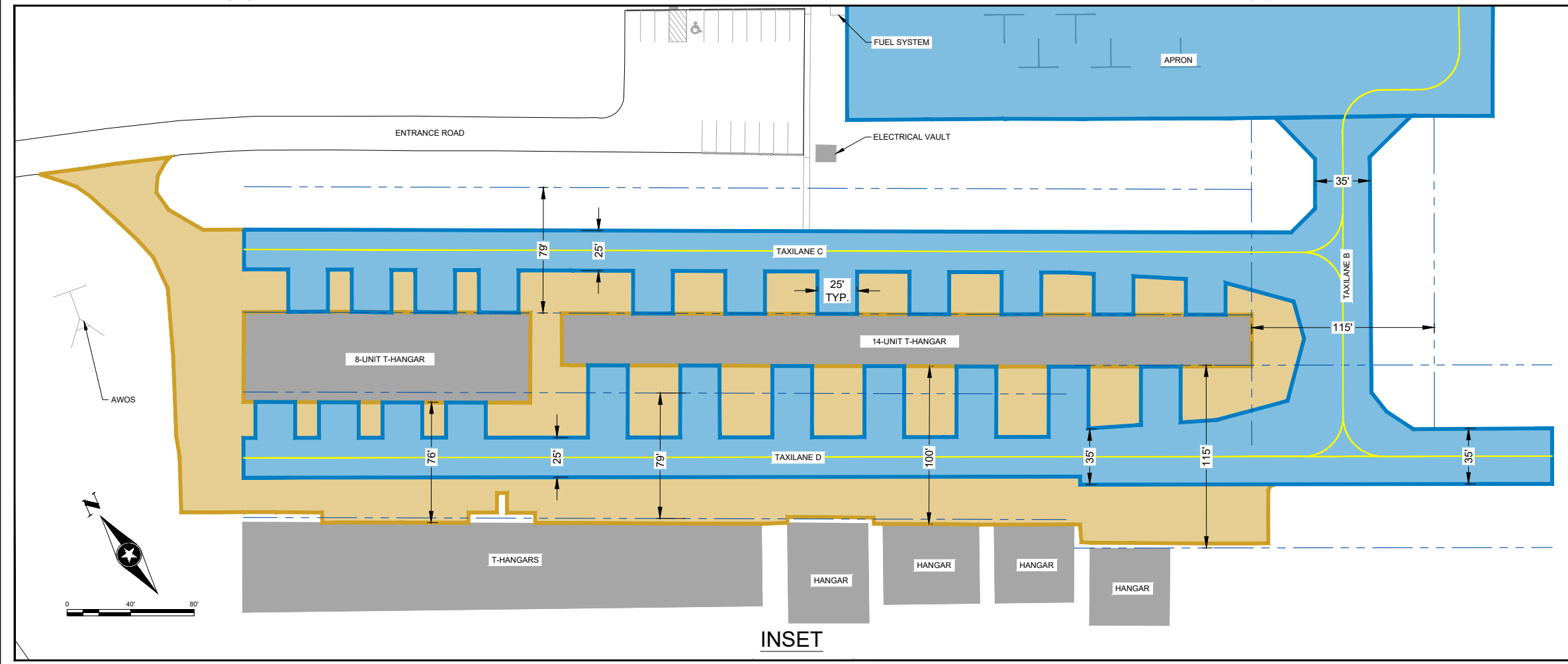
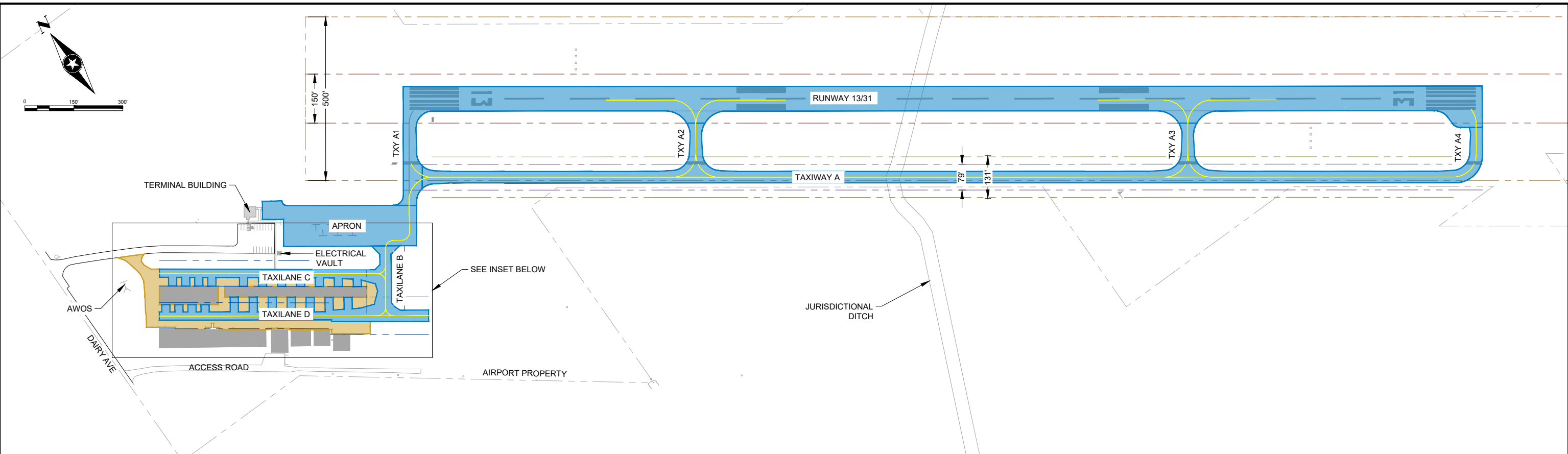

- LEGEND**
- RUNWAY SAFETY AREA (150')
 - RUNWAY OFA (500')
 - TAXIWAY SAFETY AREA (ADG II - 79')
 - TAXIWAY OFA (ADG II - 131')
 - TAXILANE OFA (ADG I - 79', ADG II - 115')
 - ELIGIBLE FOR AIP FUNDING (532,000 SF)
 - INELIGIBLE FOR AIP FUNDING/ELIGIBLE FOR STATE FUNDING (55,000 SF)

SEH Project	GLENC_182487	Rev.#	Plan Revision Issue Description	Date	Rev.#	Sheet Revision Issue Description	Date
Drawn By	KMM	#	#	#	#	#	#
Designed By	KMM	#	#	#	#	#	#
Checked By	AVE	#	#	#	#	#	#

I HEREBY CERTIFY THAT THIS PLAN WAS PREPARED BY ME OR UNDER MY DIRECT SUPERVISION AND THAT I AM A DULY LICENSED PROFESSIONAL ENGINEER UNDER THE LAWS OF THE STATE OF MN.

Adinda Van Espen
 ADINDA VAN ESPEN, PE
 DATE: 02/03/2025 LICENSE NO. 55501

2025 PAVEMENT MAINTENANCE
 GLENCOE, MN

PAVEMENT ELIGIBILITY FIGURE

G300

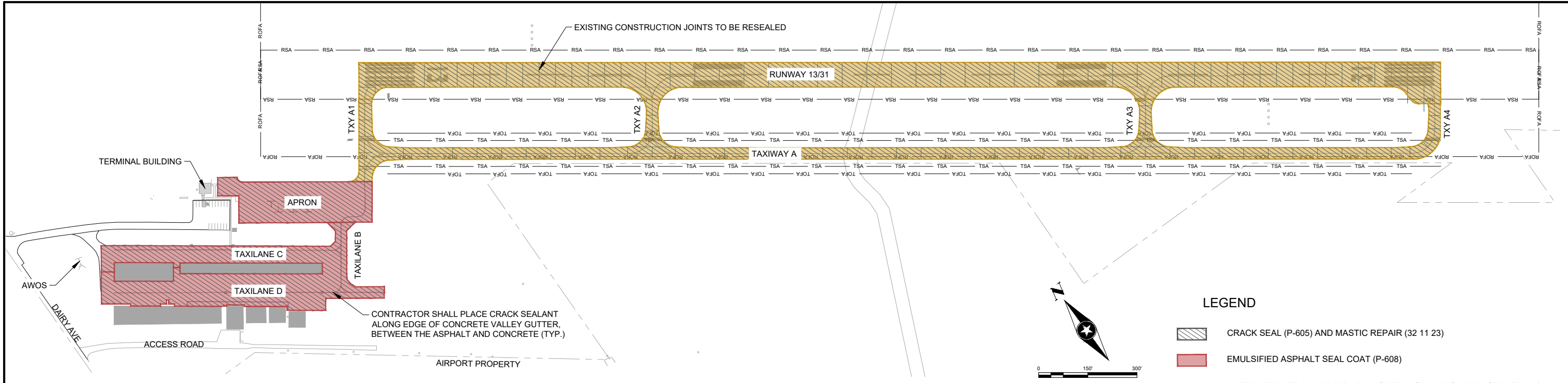

LEGEND

- CRACK SEAL (P-605) AND MASTIC REPAIR (32 11 23)
- EMULSIFIED ASPHALT SEAL COAT (P-608)
- ALTERNATE 1 (IF AWARDED) - EMULSIFIED ASPHALT SLURRY SEAL (P-626)
OR
ALTERNATE 2 (IF AWARDED) - EMULSIFIED ASPHALT SEAL COAT (P-608)

TOTAL STATEMENT OF ESTIMATED QUANTITIES							
Line No.	Item No.	Item Description	Unit	Estimated Quantity	AIP Eligible Quantity	AIP Ineligible Quantity	Final Quantity
Base Bid							
1	GENERAL	Traffic Provisions / Airport Security / Phasing	LS	1	1	0	
2	C-105	Mobilization	LS	1	1	0	
3	01 55 15	Maintenance and Restoration of Haul Road	LS	1	1	0	
4	P-605-5.1	Crack Seal (Route and Seal)	LF	10,500	10,000	500	
5	P-605-5.2	Joint Repair (Reseal)	LF	30,000	30,000	0	
6	32 11 23	Mastic 2 Part Crack Repair - (Clean, Fill, Seal) Filler	LB	500	500	0	
7	32 11 23	Mastic 2 Part Crack Repair - (Clean, Fill, Seal) Sealant	LB	1,000	1,000	0	
8	P-608	Emulsified Asphalt Seal Coat	SY	19,800	13,700	6,100	
9	P-620	Pavement Markings (Incl. Reflective Beads)	SF	1,200	1,200	0	
Alternate 1 - Slurry Seal Runway & Taxiway							
10	GENERAL	Traffic Provisions / Airport Security / Phasing	LS	1	1	0	
11	C-105	Mobilization	LS	1	1	0	
12	01 55 15	Maintenance and Restoration of Haul Road	LS	1	1	0	
13	P101	Removal of Foreign Substances/Contaminates	LS	1	1	0	
14	P-626	Emulsified Asphalt Slurry Seal Surface Treatment	SY	45,500	45,500	0	
15	P-620	Pavement Markings (Incl. Reflective Beads)	SF	18,000	18,000	0	
Alternate 2 - Seal Coat Runway & Taxiway							
16	GENERAL	Traffic Provisions / Airport Security / Phasing	LS	1	1	0	
17	C-105	Mobilization	LS	1	1	0	
18	01 55 15	Maintenance and Restoration of Haul Road	LS	1	1	0	
19	P101	Removal of Foreign Substances/Contaminates	LS	1	1	0	
20	P-608	Emulsified Asphalt Seal Coat	SY	45,500	45,500	0	
21	P-620	Pavement Markings (Incl. Reflective Beads)	SF	18,000	18,000	0	
SEQ Notes:							
2, 11, 17	Mobilization limited to 10% of total project cost						
8	This item includes the apron and taxiway areas. Aggregate not required for application.						
9, 15, 21	Pavement markings will be paid based on actual painted area of marking.						
13, 19	Includes the cost of pavement marking removal on all airfield pavements, including Runway 13/31, the parallel taxiway, as well as the apron and taxiway pavements..						
20	This item includes the Runway and Taxiway. Aggregate required for application.						

RUNWAY ESTIMATED BREAKDOWN			
Crack Seal (Route and Seal)	LF	5,000	
Joint Repair (Reseal)	LF	18,000	
2 Part Crack Repair - (Clean, Fill, Seal) Filler	LB	500	
2 Part Crack Repair - (Clean, Fill, Seal) Sealant	LB	1,000	
Surface Treatment	SY	29,000	
Pavement Markings	SF	15,000	
TAXIWAY AND CONNECTORS ESTIMATED BREAKDOWN			
Crack Seal (Route and Seal)	LF	2,000	
Joint Repair (Reseal)	LF	10,000	
2 Part Crack Repair - (Clean, Fill, Seal) Filler	LB	0	
2 Part Crack Repair - (Clean, Fill, Seal) Sealant	LB	0	
Surface Treatment	SY	16,500	
Pavement Markings	SF	3,000	
APRON ESTIMATED BREAKDOWN			
Crack Seal (Route and Seal)	LF	1,000	
Joint Repair (Reseal)	LF	2,000	
2 Part Crack Repair - (Clean, Fill, Seal) Filler	LB	0	
2 Part Crack Repair - (Clean, Fill, Seal) Sealant	LB	0	
Surface Treatment	SY	6,100	
Pavement Markings	SF	200	
TAXILANES ESTIMATED BREAKDOWN (ELIGIBLE)			
Crack Seal (Route and Seal)	LF	2,000	
Joint Repair (Reseal)	LF	0	
2 Part Crack Repair - (Clean, Fill, Seal) Filler	LB	0	
2 Part Crack Repair - (Clean, Fill, Seal) Sealant	LB	0	
Surface Treatment	SY	7,600	
Pavement Markings	SF	1,000	
TAXILANES ESTIMATED BREAKDOWN (INELIGIBLE)			
Crack Seal (Route and Seal)	LF	500	
Joint Repair (Reseal)	LF	0	
2 Part Crack Repair - (Clean, Fill, Seal) Filler	LB	0	
2 Part Crack Repair - (Clean, Fill, Seal) Sealant	LB	0	
Surface Treatment	SY	6,100	
Pavement Markings	SF	0	

Save: 2/10/2025 1:03 PM kmarchiak Plot: 2/10/2025 1:09 PM X:\F\G\GLENCOE\182487\5-final-dsgn\51-drawings\65-Aviation\Pavement Maintenance\Plans\GYL_182487-PLAN.dwg

SEH Project	GLENCOE_182487
Drawn By	KMM
Designed By	KMM
Checked By	AVE

Rev.#	Plan Revision Issue Description	Date	Rev.#	Sheet Revision Issue Description	Date
#	#	#	#	#	#
#	#	#	#	#	#
#	#	#	#	#	#

I HEREBY CERTIFY THAT THIS PLAN WAS PREPARED BY ME OR UNDER MY DIRECT SUPERVISION AND THAT I AM A DULY LICENSED PROFESSIONAL ENGINEER UNDER THE LAWS OF THE STATE OF MN.

Adinda Van Espen
 ADINDA VAN ESPEN, PE
 DATE: 02/03/2025 LICENSE NO. 55501

2025 PAVEMENT MAINTENANCE
 GLENCOE, MN

PAVEMENT MAINTENANCE PLAN AND QUANTITIES C100

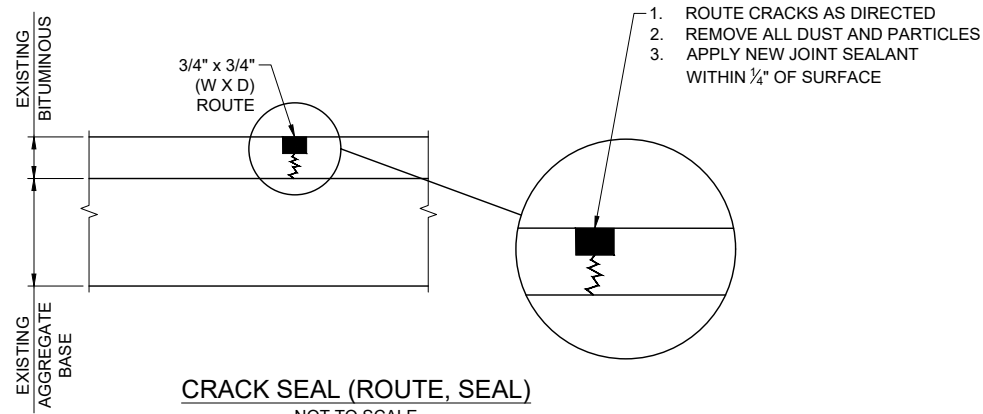

CRACK SEAL (ROUTE, SEAL)
NOT TO SCALE
(LOCATIONS TO BE MARKED IN FIELD BY ENGINEER)

CRACK SEAL NOTES

1. ROUTE CRACK $\frac{3}{4}$ "x $\frac{3}{4}$ ".
2. REMOVE ALL DUST AND PARTICLES.
3. HEAT EXISTING BITUMINOUS ADJACENT TO CRACK.
4. APPLY CRACK SEALANT, P-605 OR APPROVED EQUAL.
5. EVEN OUT MATERIAL IN CRACK AND CONSTRUCT OVERBAND.
6. ALL "SWEEPINGS" OF ROUTED MATERIAL SHALL BE HAULED/DISPOSED OF OFF-SITE.

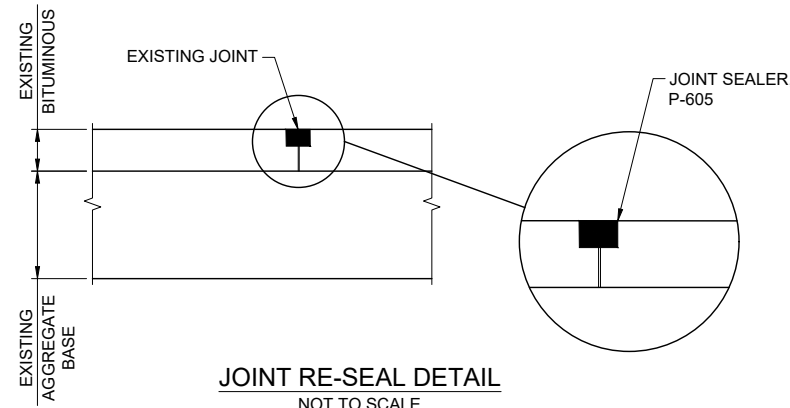

JOINT RE-SEAL DETAIL
NOT TO SCALE

JOINT RE-SEAL NOTES

1. REMOVE ALL DUST AND PARTICLES.
2. HEAT EXISTING BITUMINOUS ADJACENT TO CRACK AND EXISTING JOINT SEALANT.
3. APPLY CRACK SEALANT, P-605 OR APPROVED EQUAL.
4. EVEN OUT MATERIAL IN CRACK AND CONSTRUCT OVERBAND.

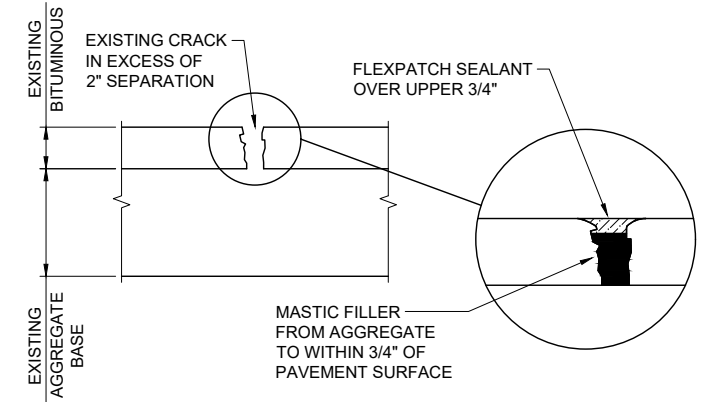

2-PART CRACK REPAIR (FLEXPATCH OVER MASTIC FILL)
NOT TO SCALE

ASPHALT MASTIC REPAIR NOTES

1. CLEAN JOINT/CRACK WITH COMPRESSED AIR, 90 PSI MINIMUM.
2. REMOVE LOOSE PIECES OF BITUMINOUS AND OLD JOINT FILLER MATERIAL.
3. HEAT EXISTING BITUMINOUS ADJACENT TO CRACK AND EXISTING JOINT SEALANT.
4. APPLY MASTIC FILLER.
5. REPEAT STEP 3, IF NECESSARY.
6. APPLY FLEXPATCH SEALANT.
7. SMOOTH MATERIAL WITH SQUEEGEE.
8. AGGREGATE/SEALANT RATIO SHALL BE 2 POUNDS OF AGGREGATE PER POUND OF SEALANT.

Save: 1/30/2025 4:47 PM kmarchiak Plot: 2/10/2025 1:09 PM X:\F\G\GLENCOE\182487\5-final-dsgn\51-drawings\65-Aviation\Pavement Maintenance\Plans\GYL_182487-DET.dwg

SEH Project	GLENC_182487	Rev.#	Plan Revision Issue Description	Date	Rev.#	Sheet Revision Issue Description	Date
Drawn By	KMM	#	#	#	#	#	#
Designed By	KMM	#	#	#	#	#	#
Checked By	AVE	#	#	#	#	#	#



I HEREBY CERTIFY THAT THIS PLAN WAS PREPARED BY ME OR UNDER MY DIRECT SUPERVISION AND THAT I AM A DULY LICENSED PROFESSIONAL ENGINEER UNDER THE LAWS OF THE STATE OF MN.
Adinda Van Espen
 ADINDA VAN ESPEN, PE
 DATE: 02/03/2025 LICENSE NO. 55501

2025 PAVEMENT MAINTENANCE
GLENCOE, MN

PAVEMENT MAINTENANCE DETAILS

C200

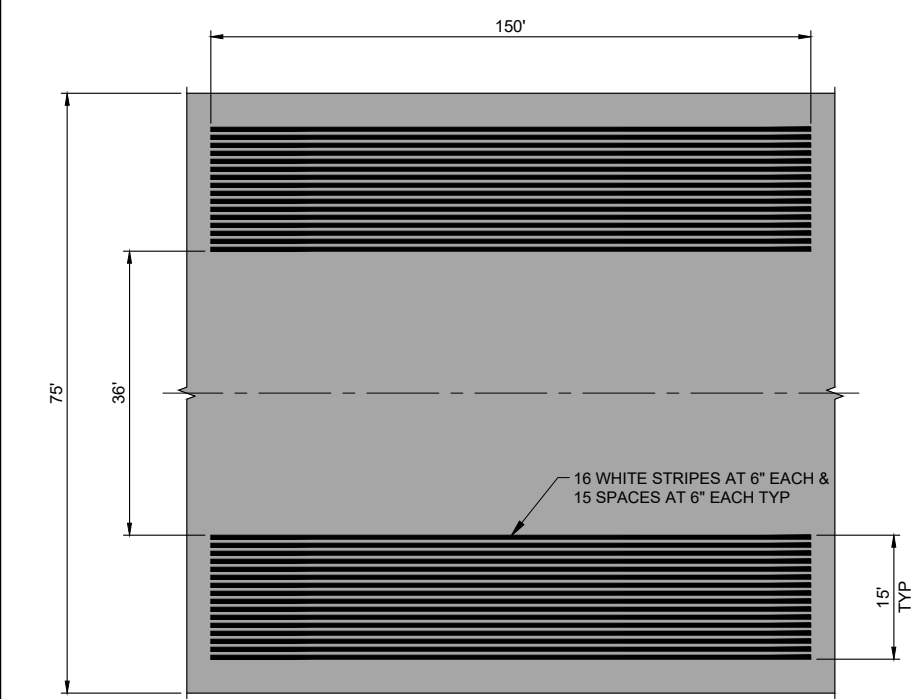
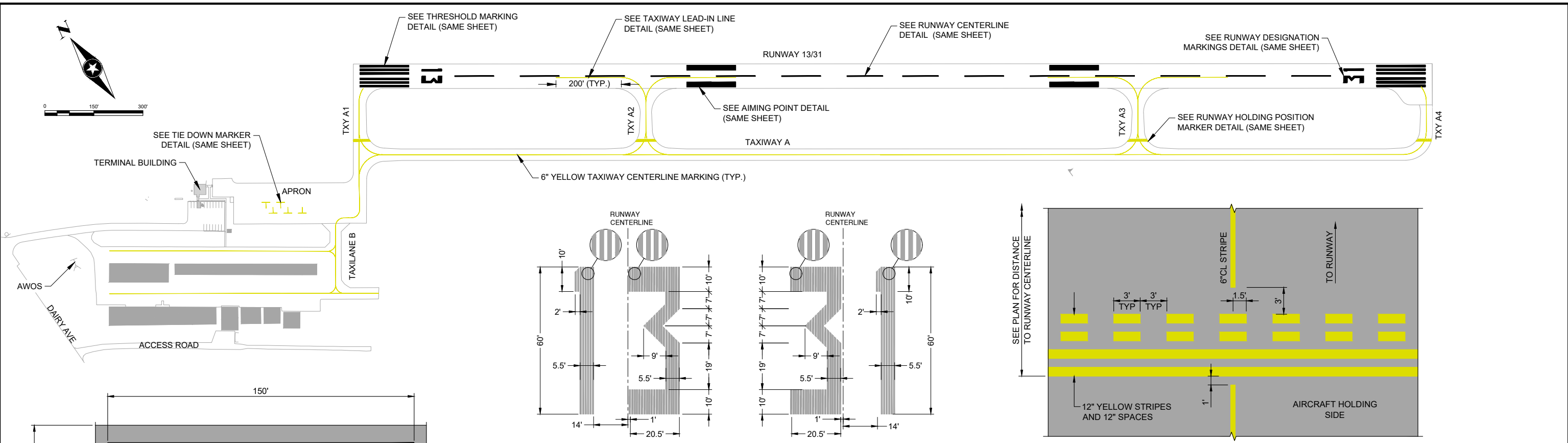

AIMING POINT DETAIL
NTS

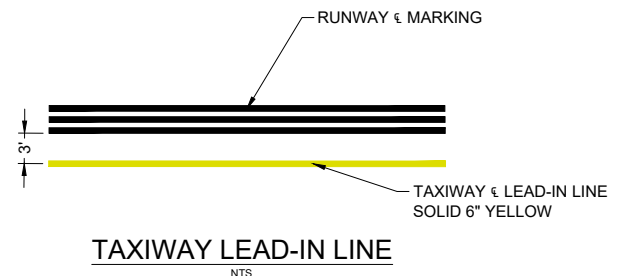

TAXIWAY LEAD-IN LINE
NTS

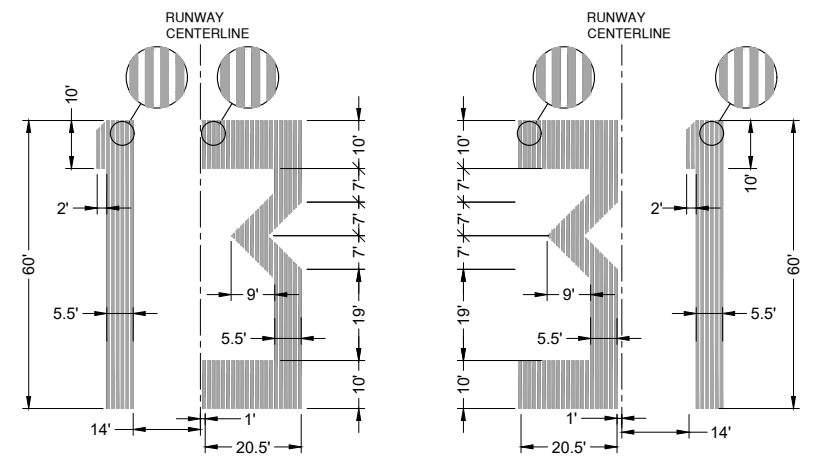

RUNWAY DESIGNATION MARKINGS
NTS

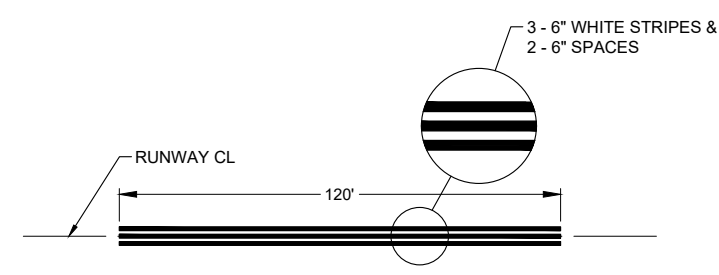

RUNWAY CENTERLINE
NTS

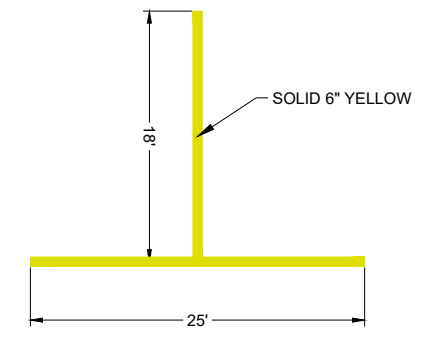

TIE DOWN MARKER
NTS

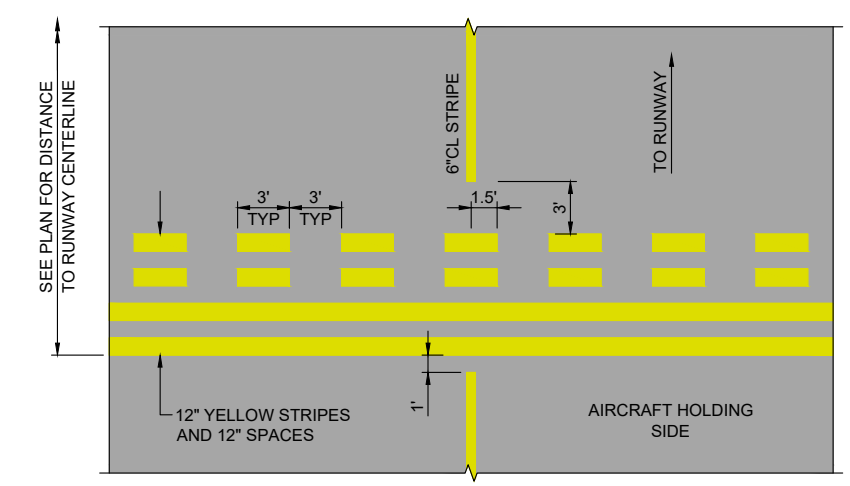

RUNWAY HOLDING POSITION MARKER
NTS

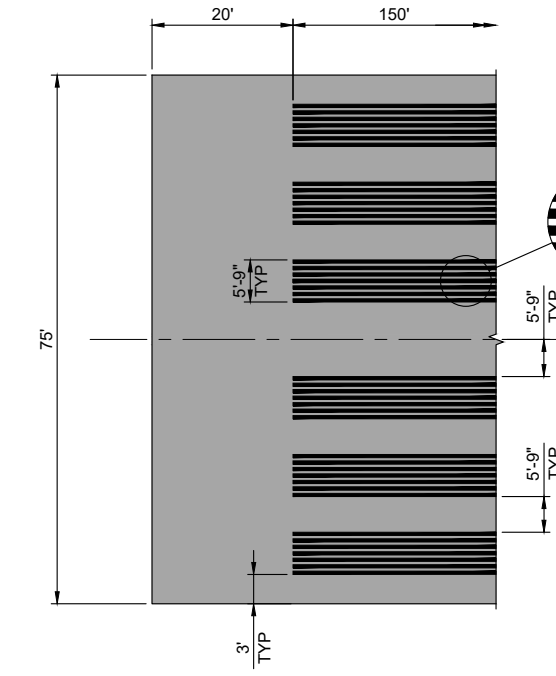

THRESHOLD MARKING DETAIL
NTS

PAVEMENT MARKING NOTES:

- IF ALTERNATE 1 OR 2 IS AWARDED, ALL EXISTING PAVEMENT MARKINGS SHALL BE REMOVED PRIOR TO PAVEMENT SEAL COAT APPLICATION.
- CONTRACTOR CAN REQUEST SURVEY FILES OF EXISTING PAVEMENT MARKINGS FROM ENGINEER. NEW PAVEMENT MARKINGS SHALL BE INSTALLED IN THE SAME LOCATION AS THE EXISTING MARKINGS UNLESS OTHERWISE NOTED ON PLAN. SURVEYING/STAKING FOR THE PLACEMENT OF THE NEW MARKINGS SHALL BE CONSIDERED INCIDENTAL TO THE PAVEMENT MARKINGS BID ITEM.
- PAVEMENT MARKING APPLICATION SHALL BE PERFORMED 30 DAYS AFTER SURFACE TREATMENT APPLICATION.
- RUNWAY CLOSURE MARKERS SHALL BE PLACED ON UN-MARKED PAVEMENT ADJACENT TO RUNWAY NUMBERS WHILE PAVEMENT MARKING OCCURS WITHIN THE RUNWAY SAFETY AREA.
- A MINIMUM OF 1 HOUR DRY TIME WILL BE REQUIRED AFTER COMPLETION OF MARKINGS PRIOR TO RE-OPENING PAVEMENTS.
- PAVEMENT MARKINGS WILL BE PAID BASED ON ACTUAL PAINTED AREA OF MARKINGS.

Save: 2/10/2025 1:06 PM kmarchiak Plot: 2/10/2025 1:09 PM X:\F\G\GLENCOE\182487\5-final-dsgn\5-drawings\65-Aviation\Pavement Maintenance\Plans\GYL_182487-PM.dwg

SEH Project	GLENC_182487	Rev.#	Plan Revision Issue Description	Date	Rev.#	Sheet Revision Issue Description	Date
Drawn By	KMM	#	#	#	#	#	#
Designed By	KMM	#	#	#	#	#	#
Checked By	AVE	#	#	#	#	#	#

I HEREBY CERTIFY THAT THIS PLAN WAS PREPARED BY ME OR UNDER MY DIRECT SUPERVISION AND THAT I AM A DULY LICENSED PROFESSIONAL ENGINEER UNDER THE LAWS OF THE STATE OF MN.

Adinda Van Espen
ADINDA VAN ESPEN, PE
DATE: 02/03/2025 LICENSE NO. 55501

2025 PAVEMENT MAINTENANCE
GLENCOE, MN

PAVEMENT MARKING PLAN C300